



1. Woleseley Road road closure to become an extension to Ibbitson Park and shared zone with pedestrian priority, increased tree canopy and increased soft landscape areas (by Council)
2. Existing Eucalyptus saligna retained and protected insitu. Current driveway alignment remains. Possibility of replacing the driveway in porous paving to be determined by arborist.
3. Existing Jacaranda in planters to be salvaged and transplanted back in deep soil landscape setback when levels reconfigured. Process managed by arborist and tree transplanter.
4. Existing street trees under powerlines retained.
5. Path reconfigured against property boundary to enlarge and rationalise path and landscape verge.
6. Paving thresholds at building entrances and building corner.
7. Local Centre Core Paving to KMC standards for public domain, precast concrete units as per the Public Domain Technical Manual.
8. 1.5m wide planted landscape strip across Pacific Highway interface with openings for commercial businesses.
9. Existing Plane trees in poor health removed and create a better path of travel for pedestrians. Health of Plane trees to be confirmed by arborist.
10. New street tree planting. Trees in pits tree growing vault with trench beneath. Species selected per public domain plan.
11. Continuous landscape strip.
12. Publicly accessible pocket park with retained trees.
13. New Eucalyptus saligna feature tree.
14. Curved edges, walls and furniture.
15. Bike parking.



## Level 1 and Communal Podium



1. Tree planters 1m deep and with sufficient volume for sustained growth. Trees are distributed across L3 Communal podium to create shade and generous greening.
2. Low maintenance small turf areas adjacent to communal gathering spaces.
3. Shade pavilions over communal gathering spaces.
4. Paved thresholds from building entrances.
5. Generous massed planting areas to control access and ensure privacy for terraces.
6. Perimeter planters at palisade for greening of the perimeter and to enhance the public domain greening to the streetscape/ railway corridor.
7. Inaccessible biodiversity roof terraces (shallow soil profile).

1 **PODIUM AND L1 LANDSCAPE**  
Scale: 1:400



0 5 10 15 20 25 M



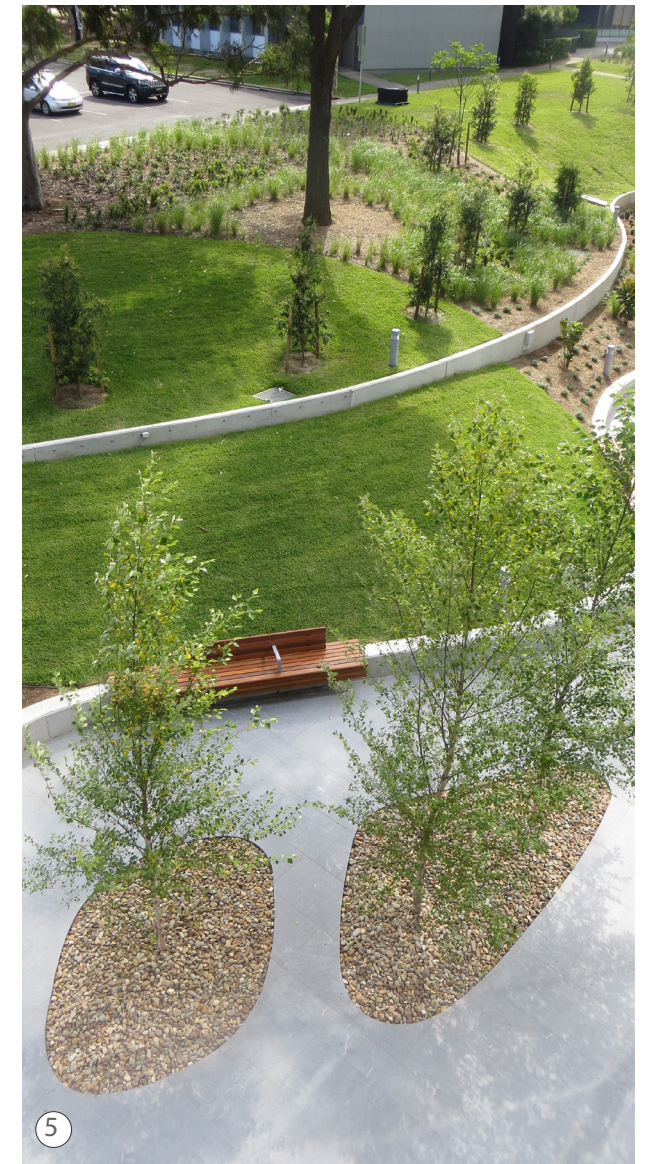
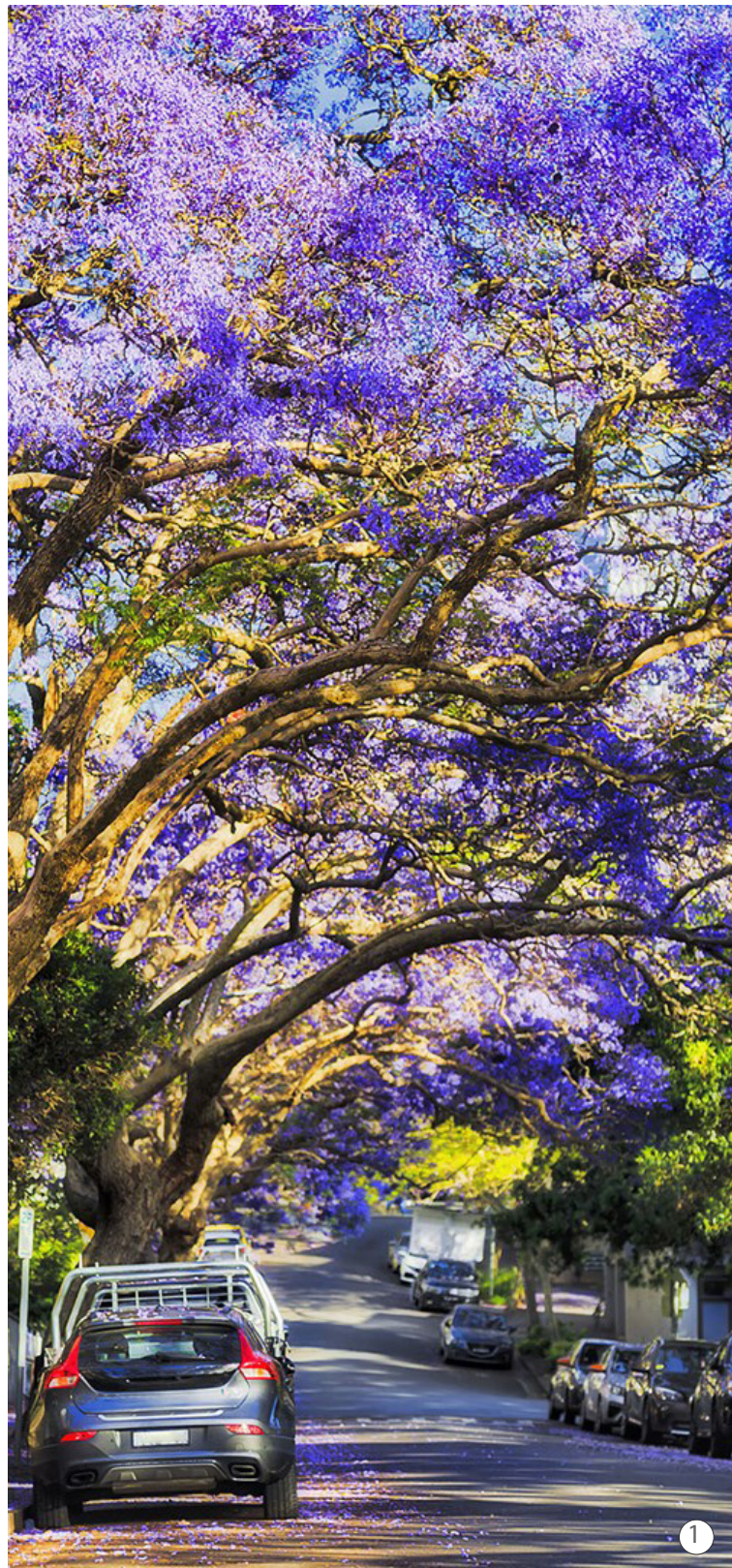

#### Public Domain and Streetscape

1. Jacarandas in street setback, salvaged and replanted.
2. Paving to Lindfield Local Centre specifications (similar to Tryon Avenue).
3. High quality paving to reference the public domain paving character and enforce the cohesion of the public space.
4. Trees within streetside deep soil trench and mass planting.
5. A tree lined pocket park adjacent to Pacific Highway, with existing and new trees , grassed area , massed planting and seats.
6. New street trees on Pacific Highway, to replace dying Plane Trees.



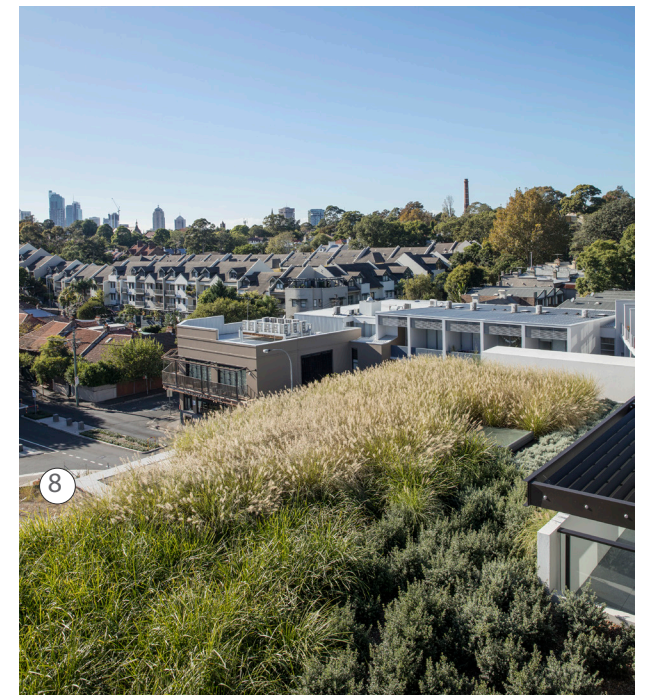
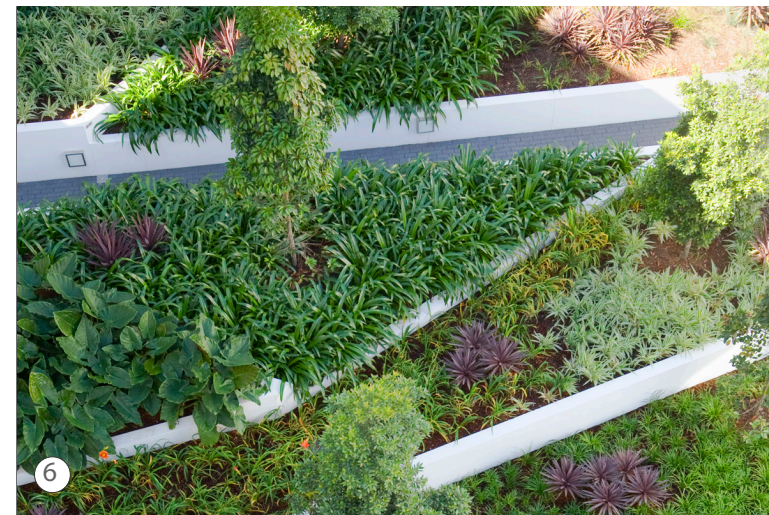
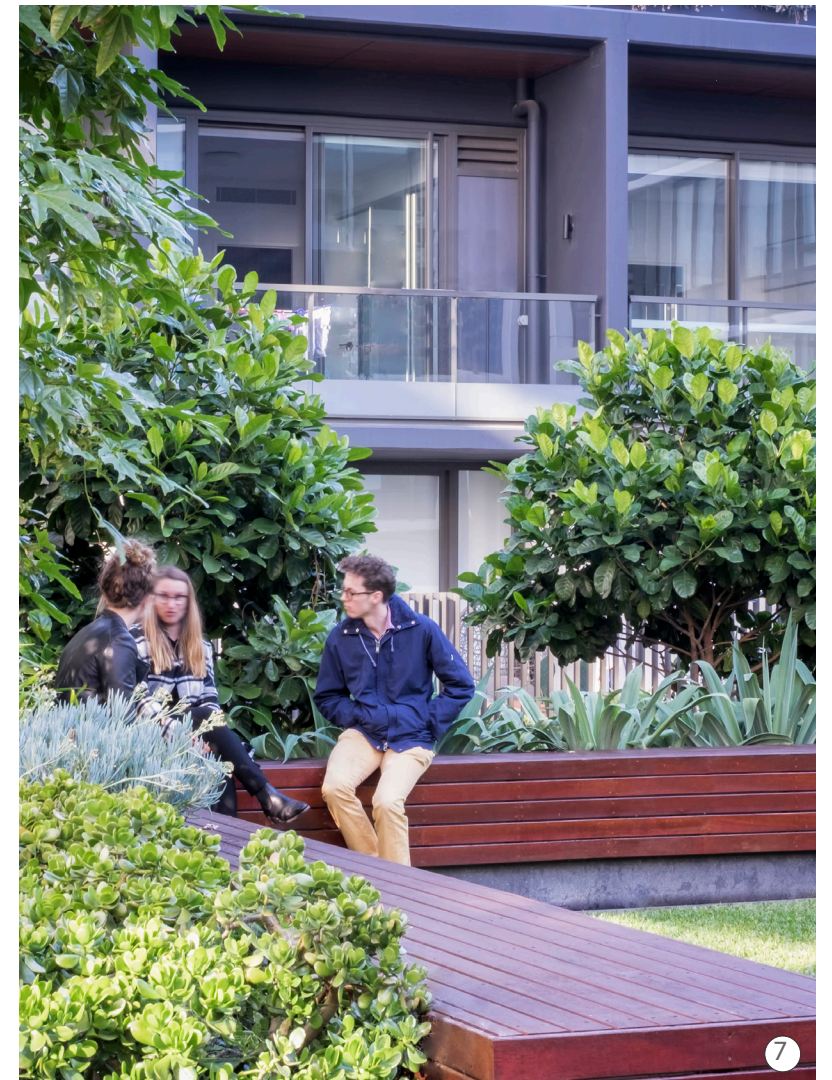
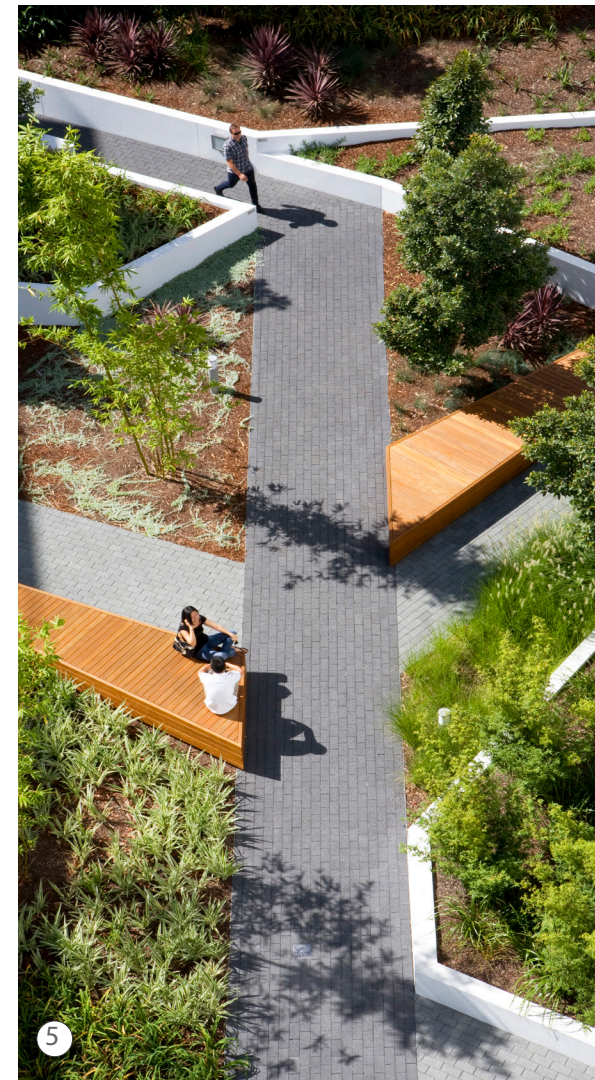

### Level 1 Biodiversity Roof and Communal Roof Podium

1. Planters of various heights over slab on communal courtyard,
2. Planters incorporate level changes for benches, seats and tree planters.
3. Biodiversity roof garden on level 1. Inaccessible except for maintenance. Diverse local native plant species to supplement rail biodiversity corridor.
4. Shade structures with paved areas underneath, and to include BBQ s and outdoor fixed furniture.
5. Strong geometry to define paths and planting.
6. Massed planting is stepped depth planters to create interest in form.
7. Seating adjacent to small turfed areas.
8. Biodiversity roof planting on Level 1.